



— Simplify your life —
AV Access

4KSW21-L VGA/HDMI Smart Switcher



[User Manual](#)

Disclaimers

The information in this manual has been carefully checked and is believed to be accurate. AV Access Technology Ltd. assumes no responsibility for any infringements of patents or other rights of third parties which may result from its use.

AV Access Technology Ltd. assumes no responsibility for any inaccuracies that may be contained in this document. AV Access Technology Ltd. also makes no commitment to update or to keep current the information contained in this document.

AV Access Technology Ltd. reserves the right to make improvements to this document and/or product at any time and without notice.

Copyright

Copy, Reproduce, Distribute and/or Edit of this document or part of it as well as utilization of its contents and communication thereof to others without express authorization are prohibited. Offenders will be held liable for payment of damages. All rights created by patent grant or registration of a utility model or design patent are reserved. Copyright ©2016 AV Access Technology Ltd. All rights reserved.

Trademarks Notice

All products or service names mentioned in this document may be trademarks of the companies with which they are associated.

Contact Us

Business inquiry: services@avaccess.com

Technical problems: support@avaccess.com

Important Safety Instructions

- Do not expose this apparatus to rain, moisture, dripping or splashing. No objects filled with liquids, such as vases, shall be placed on the apparatus.
- Do not install or place this unit in a bookcase, built-in cabinet, or in another confined space. Ensure the unit is well ventilated.
- To prevent risk of electric shock or fire hazard due to overheating, do not obstruct the unit's ventilation openings with newspapers, tablecloths, curtains, or similar items.
- Do not install near any heat sources such as radiators, heat registers, stoves, or other apparatus (including amplifiers) that produce heat.
- Do not place sources of naked flames, such as lighted candles, on the unit.
- Clean this apparatus only with dry cloth.
- Unplug this apparatus during lightning storms or when unused for long periods of time.
- Protect the power cord from being walked on or pinched, particularly at plugs.
- Only use attachments / accessories specified by the manufacturer.
- Refer all servicing to qualified service personnel.

Table of Contents

Introduction.....	2
Overview	2
Package Contents.....	3
Panel.....	4
Front Panel.....	4
Rear Panel.....	5
Installation Instructions.....	6
Installation Requirements.....	6
Specification.....	7
Trouble Shooting.....	9
Steps of Regular Troubleshooting Routine.....	9
Warranty.....	10

Introduction

Overview

4KSW21-L is a VGA/HDMI Smart Switcher with direct CEC control, offering one HDCP compliant HDMI input, a VGA with analog stereo audio input, and an HDMI output up to 4K@60Hz (Chroma sub-sampling 4:2:0 8-bit only) without scaler.

Its built-in CEC controller allows user to directly switch the power status of CEC-supported display device, such as TV or projector, eliminating the need of IR Remote. Select buttons in the front panel help users to choose input sources, or power on/off display device.

- 1 x VGA + 3.5mm stereo audio input, up to 1920x1200@60Hz.
- 1 x HDMI input, up to 4k@60Hz (Chroma sub-sampling 4:2:0 8-bit only).
- Auto-sense and switching. VGA has higher priority over HDMI if both are connected.
- CEC controller built in to power on/standby sink device by auto-detecting the source status.
- Switch source devices or power on/ standby of display devices via select buttons.
- Adjust the working mode via "Switch" and "CEC" DIP switch.

Package Contents

Before you start the installation of the product, please check the package contents:

- VGA/HDMI Switcher 4KSW21-L x 1
- Power Supply (DC 12V 0.5A) x 1
- Mounting Brackets (Pair) x 1
- User Manual x 1

Panel

Front Panel



ID	Name	Description
1	VGA IN	Connects to VGA sources
2	L/R	VGA analog stereo audio input
3	HDMI IN	Connects to HDMI sources
4	VGA LED	Lit when VGA source is selected
5	Select Button	Press this button to select VGA IN
6	Select Button	Press this button to select HDMI IN

ID	Name	Description
7	HDMI LED	Lit when HDMI source is selected
8	Select Buttons	Power on/off the display devices via CEC. Note: The display device must support CEC and CEC must be enabled.

Rear Panel



ID	Name	Description
1	Power Input	DC 12V 0.5A power input
2	Power LED	Indicates power status
3	HDMI OUT	Connects to an HDMI display device
4	Switch	Auto: It becomes an auto-switcher and VGA has higher priority over HDMI if both are connected.
5	CEC	Auto: It sends CEC command to power on/off sink device by auto-detecting whether the input source status is active or not. MANU: Manual button CEC control is enabled.

Installation Instructions

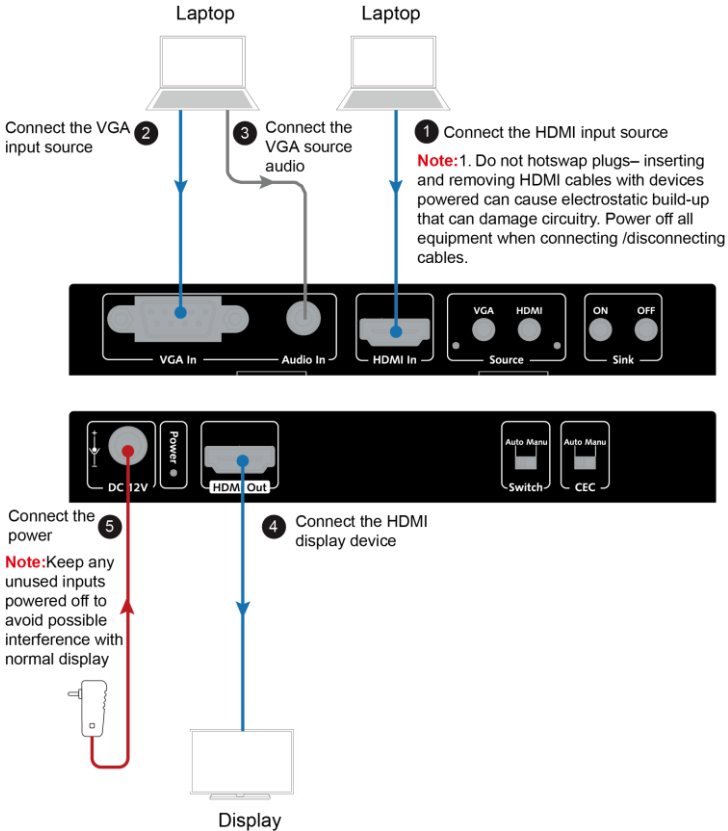

Installation Requirements

1. The HDMI source may be any device such as Blu-Ray, Apple TV etc.
2. The VGA source may be any device such as PC, notebook etc.
3. Enable the CEC function of the display device so that users can control the display device via CEC.
4. To ensure proper functionality, please set the resolution of the HDMI sources under 4K@60Hz 4:2:0 8bit.

Specification

Video	
Input	1 x HDMI , 1 x VGA
Input Signal Type	HDMI: HDMI1.4 with HDCP , VGA: VESA
Input Resolution Support	HDMI: 4096x2160@24/25/30/50/60Hz, 3840x2160@24/25/30/50/60Hz, 1080P, 1080I, 720P, 576p, 576i, 480p, 480i; VGA: 1920x1200/1920x1080/1680x1050/1600x1200/1600x900/1400x1050/1440x900/1366x768/1280x1024/1280x800/1280x768/1280x720/1024x768/800x600/640x480@60Hz
Maximum Pixel Clock	HDMI: 340MHz VGA: 165MHz
Output	1 x HDMI
Output Signal Type	HDMI: HDMI 1.4 with HDCP
Output Resolution Support	HDMI: 4096x2160@24/25/30/50/60Hz, 3840x2160@24/25/30/50/60Hz, 1080P, 1080I, 720P, 576p, 576i, 480p, 480i; VGA: 1920x1200/1920x1080/1680x1050/1600x1200/1600x900/1400x1050/1440x900/1366x768/1280x1024/1280x800/1280x768/1280x720/1024x768/800x600/640x480@60Hz
Audio	
Input	Digital audio: Embedded in HDMI inputs

Specification

	Analog audio: Stereo
Input Signal Type	Digital audio: Stereo, LPCM 5.1, LPCM 7.1; Dolby True HD, DTS-HD Master Audio Analog audio: Stereo
Output	Digital audio: Embedded in HDMI outputs
Output Signal Type	Same as input
Control	
Control Method	Front Panel Button, CEC
General	
Operating Temperature/ Humidity	0°C ~ 45°C (32°F ~ 113 °F), 10% ~ 90%, non-condensing
Storage Temperature/ Humidity	-20°C ~ 70°C (-4°F ~ 158 °F), 10% ~ 90%, non-condensing
Power Supply	12V 0.5A
Product Weight	220g/0.48lb
Power Consumption	1.5W Max
Product Dimensions	141.8mm x 64.2mm x 20mm/5.58" x 2.53" x 0.79"
ESD Protection	Human-body Model: ±8kV(Air-gap discharge)/ ±4kV(Contact discharge)

Cable Specification:

Cable Type	Range	Supported Video
HDMI Cable	Input/Output: Up to 33ft (10m)	4K@60 Hz 4:2:0 8bit,
	Input: Up to 33ft (10m), Output: Up to 49ft (15m)	1080P@60Hz

Trouble Shooting

Steps of Regular Troubleshooting Routine

1. **Power:** Make sure all devices are powered on (source, switcher and display devices).
2. **Indicator:** Make sure LED indicators of switcher are normal according to user manual.
3. **Devices:** Make sure picture can be shown normally when connecting sources to display device directly.
4. **Cable:** Plug in and out the HDMI cable or change to another HDMI cable. Ensure the cable length is within the available transmission range according to the specification.
5. **Compatibility:** Please test other source and display devices to determine if it is a compatibility issue.

Warranty

Products are backed by a limited 1-year parts and labor warranty. For the following cases AV Access shall charge for the service(s) claimed for the products if the product is still remediable and the warranty card becomes unenforceable or inapplicable.

1. The original serial number (specified by AV Access) labeled on the product has been removed, erased, replaced, defaced or is illegible.
2. The warranty has expired.
3. The defects are caused by the fact that the product is repaired, dismantled or altered by anyone that is not from an AV Access authorized service partner. The defects are caused by the fact that the product is used or handled improperly, roughly or not as instructed in the applicable User Guide.
4. The defects are caused by any force majeure including but not limited to accidents, fire, earthquake, lightning, tsunami and war.
5. The service, configuration and gifts promised by salesman only but not covered by normal contract.
6. AV Access preserves the right for interpretation of these cases above and to make changes to them at any time without notice.

Thank you for choosing products from AV Access.



AV Access — *Simplify your life* —

AV Access Technology Limited